

RMG-FS AND ASSOCIATED PARTS

STANDARD RUBBER MOLDED

IN-LINE SERIES

Note: Available with grippers, must specify.

Material: Special Neoprene, Molded
 Contacts: Copper Alloy, Hard Gold Plated per ASTM-B-488
 Voltage Rating: 600 VDC-contact factory for higher voltage requirements
 Pressure Rating, Mated: up to 20,000 psi

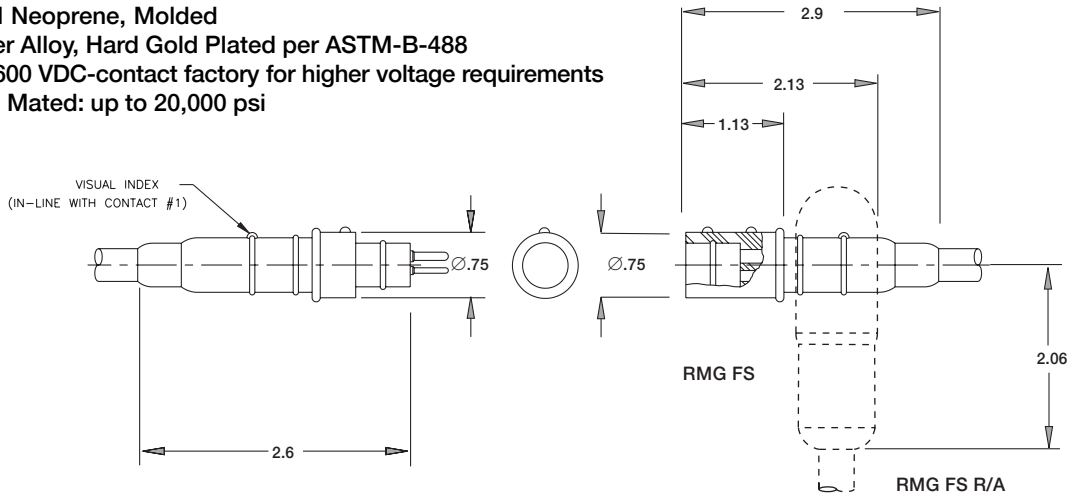

RMG-MP

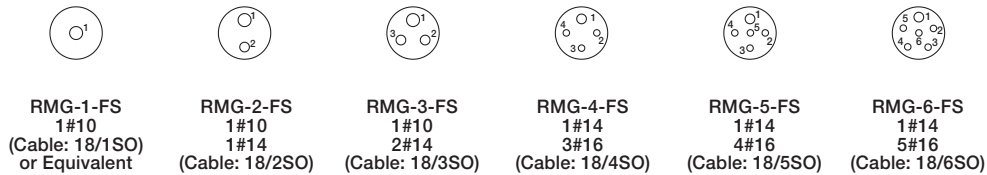

WOC CONNECTORS

Note: WOC stands for "without cable." The connectors are supplied as shown below for installation in the field and/or to non-neoprene jacketed cables, Bonding can be achieved by molding to the connectors shown using polyurethane with appropriate primers.

Part Name: RMG-FS WOC, RMG-MP WOC

Material: Special Neoprene, Molded
 Contacts: Brass, Hard Gold Plated per ASTM-B-488
 Voltage Rating: 600 VDC-contact factory for higher voltage requirements
 Pressure Rating, Mated: up to 20,000 psi

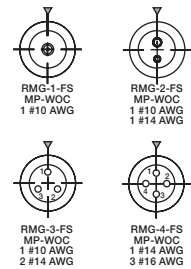
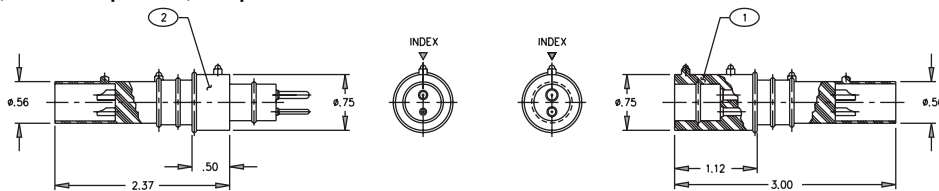

LOCKING SLEEVES

Note: Must specify cable OD when using G-FLS-X

G-MLS-D (AVAILABLE FOR RMG-MP, RMG-MP WOC)
 G-FLS-D (AVAILABLE FOR RMG-FS, RMG-FS-R/A,
 RMG-FS WOC)
 G-MLS-S (AVAILABLE FOR RMG-MP, RMG-MP WOC)
 G-FLS-S (AVAILABLE FOR RMG-FS, RMG-FS-R/A,
 RMG-FS WOC)
 G-FLS-X (AVAILABLE FOR RMG-FS) Must specify cable O.D.
 when ordering G-FLS-X

DUMMY CONNECTORS

Note: specify number of conductors when ordering

RMG-FSD MATES TO RMG-MP, BCL & XSG-BCL,
 XSG-PBC, XSG-PBCL & XSG-PBCLM
 RMG-MPD MATES TO RMG-FS & RMG FS-R/A

MATERIAL: SPECIAL NEOPRENE, MOLDED
 PRESSURE RATING, MATED:
 RMG-FSD (20,000 PSI)
 RMG-MPD-LP (LOW PRESSURE ≤ 4,000 PSI)
 RMG-MPD-HP (4,000 PSI-20,000 PSI) Contact Required

RMG-FS AND ASSOCIATED PARTS

MATEABLE BULKHEAD CONNECTORS

BULKHEAD CONNECTORS

(MATES TO RMG FS & RMG-FS-R/A & RMG FS WOC)

Dummy Connector RMG FS D

Part Name: **RMG-BCL**

Material: 316 Stainless St., Internal Insulation-Special Neoprene

Contacts: Copper Alloy, Hard Gold Plated per ASTM-B-448

Pressure Rating, Mated: up to 20,000 psi

RMG-BCL; Special Insulating neoprene is permanently molded to the metal shell. These types of connectors are used where physical abuse would be too great for the non-metallic (glass reinforced epoxy) series. The RMG BCL has a locking sleeve provision and utilizes a facial O-ring seal to the bulkhead.

Part Name: **XSG-BCL**

Material: Glass Reinforced Epoxy

Contacts: Copper Alloy, Hard Gold Plated per ASTM-B-448

Pressure Rating, Mated: up to 20,000 psi

XSG-BCL; One of our oldest connectors in the non-metallic series, with male pin as shown. Connector is one homogeneously molded unit. Available with different thread lengths as indicated. The XSG BCL has a locking sleeve provision and utilizes a facial O-ring seal to the bulkhead.

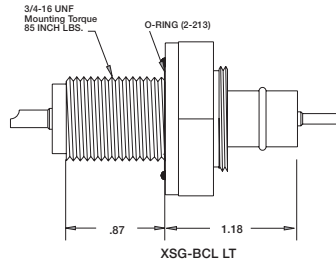
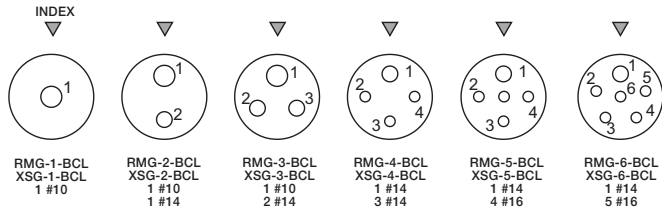
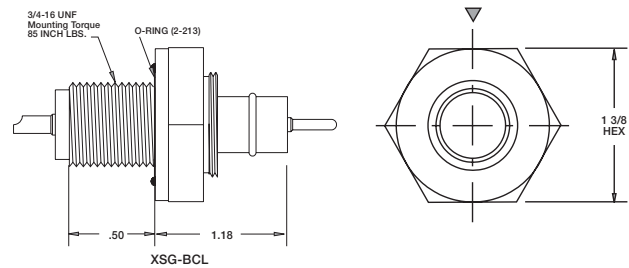
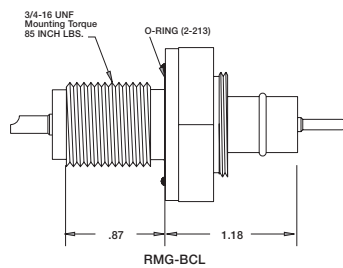

Part Name: **XSG-BCL-P-R/A**

Material: Glass Reinforced Epoxy

Contacts: Copper Alloy, Hard Gold Plated per ASTM-B-448

Pigtails; teflon insulated #18 AWG

Pressure Rating, Mated: up to 20,000 psi

XSG-BCL-P-R/A; A non-metallic low profile right angle bulkhead connector featuring a locking sleeve provision and utilizing a facial o-ring seal to the bulkhead.

NOTE: Torque values referenced in this literature assume installation into dry metal threads. Please contact the factory for recommendations.

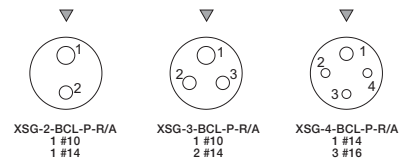
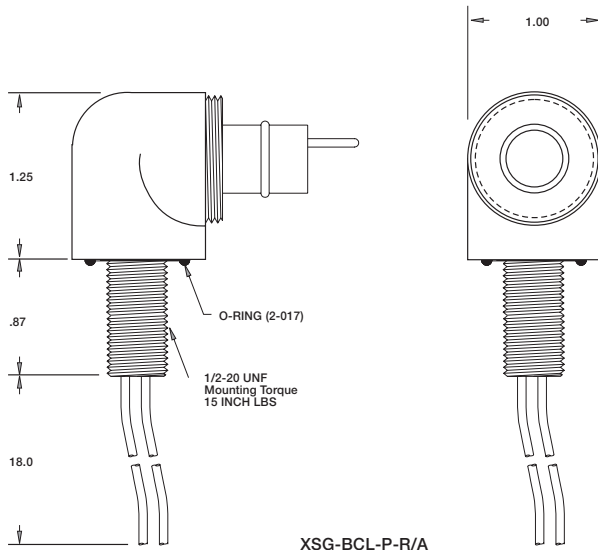

RMG-FS AND ASSOCIATED PARTS

MATEABLE BULKHEAD CONNECTORS

BULKHEAD CONNECTORS & MOUNTING REQUIREMENT
 (MATES TO RMG FS & RMG-FS-R/A & RMG-FS WOC)
 Dummy Connector: RMG-FSD

Part Name: **XSG-PBC, XSG-PBCL**

Material: Glass Reinforced Epoxy

Contacts: Copper Alloy, Hard Gold Plated per ASTM-B-488

Pigtails: teflon insulated #18 AWG

Pressure Rating, Mated: up to 5,000 psi

XSG-PBC; Small footprint non-metallic connector utilizing an o-ring in the thread relief area to seal to the bulkhead.

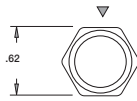
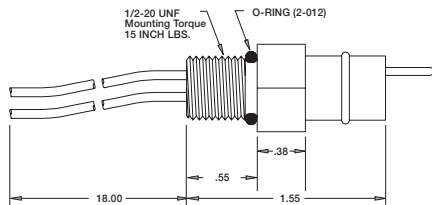

XSG-PBC

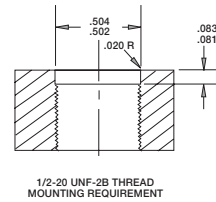
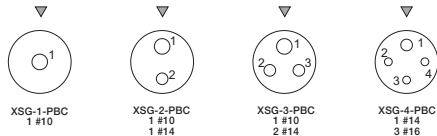

1/2-20 UNF-2B THREAD MOUNTING REQUIREMENT

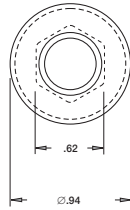
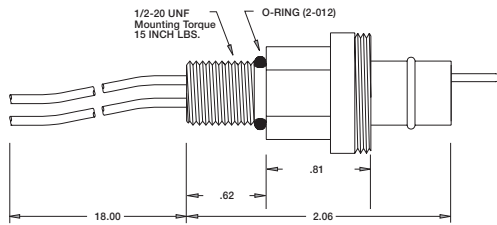

XSG-PBCL

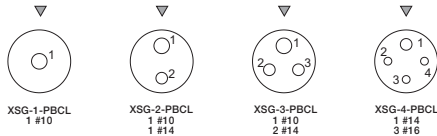

XSG-PBCL; Small footprint non-metallic connector utilizing an o-ring in the thread relief area to seal to the bulkhead. Features a locking sleeve provision.

Part Name: **XSG-PBCLM**

Material: Glass Reinforced Epoxy

Contacts: Copper Alloy, Hard Gold Plated per ASTM-B-488

Pigtails: teflon insulated #18 AWG

Pressure Rating, Mated: up to 5,000 psi

XSG-PBCLM; Non-metallic connector utilizing a facial o-ring seal to the bulkhead. Features a locking sleeve provision.

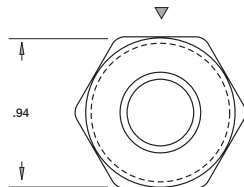
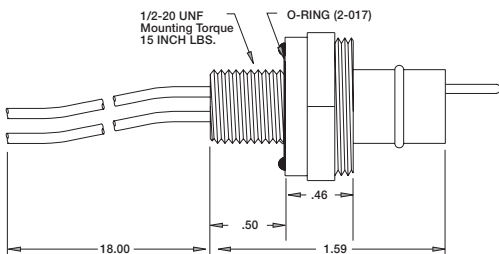

XSG-PBCLM

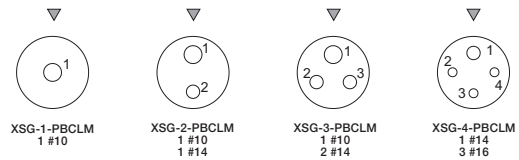

NOTE: Torque values referenced in this literature assume installation into dry metal threads. Please contact the factory for recommendations.

RMG-FS AND ASSOCIATED PARTS

MATEABLE BULKHEAD CONNECTORS

BULKHEAD CONNECTORS

(MATES TO RMG FS & RMG-FS-R/A & RMG-FS WOC)

Dummy Connector: RMG-FSD

Part Names: **RMGS-BC, RMGS-BCL**

Material: 316 Stainless Steel

Contacts: Copper Alloy, Hard Gold Plated per ASTM-B-488

Pressure Rating, Mated: up to 5,000 psi

RMGS-BC; Features a stainless steel body, insulating neoprene, and pipe thread for sealing to bulkhead. No O-Ring required for sealing.

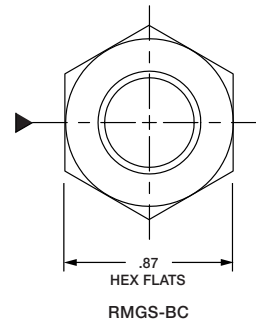
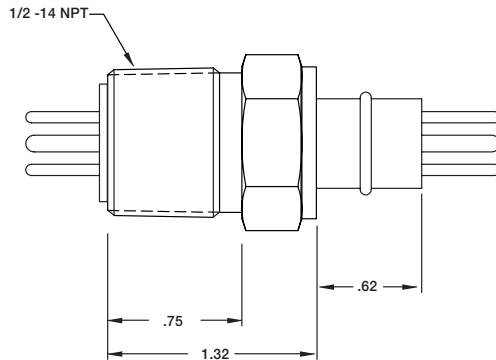

RMGS-BCL; Features a stainless steel body, insulating neoprene, and pipe thread for sealing to bulkhead. No O-Ring required for sealing. Features a locking sleeve provision.

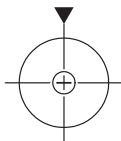
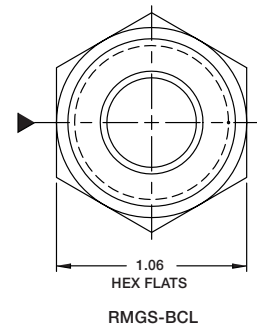
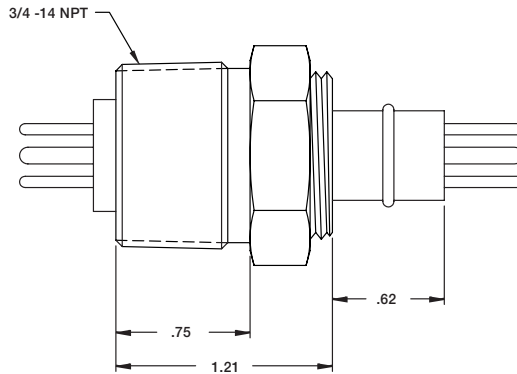

RMGS-1-BC/BCL
1 #10 AWG

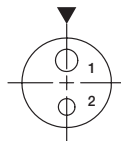

RMGS-2-BC/BCL
1 #10 AWG
1 #14 AWG

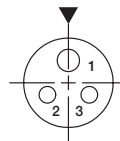

RMGS-3-BC/BCL
1 #10 AWG
2 #14 AWG

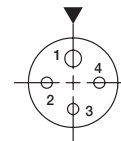

RMGS-4-BC/BCL
1 #14 AWG
3 #16 AWG

NOTE: Torque values referenced in this literature assume installation into dry metal threads. Please contact the factory for recommendations.